

## MIXER

**ALTINBILEK brand Mixers** are industrial machines that provide a homogeneous mixture of dry raw materials in ground powder form, vials, wastes or grains in grain form. It is produced in various mixing volumes between “200 - 18.000” liters, in padded and helical models depending on the usage situation and demands. It is designed with single shaft and double shaft options. These mixers which are used in the feed, flour, chemical and recycling industries, provide high homogeneous mixing results in a minimum of time through their unique rotor and body structure. Thanks to the innovative design of the mixing rotor, when the appropriate system flow rate is achieved, it can mix 10-20 times per hour at a mixing ratio of 1: 100,000 with a variation coefficient (CV) of 1.5% - 5%. Thus, maximum efficiency is provided in the areas where the products are used. Through the special entry points and nozzles on the mixers, oil, water and various liquid additives can be injected into the product that is mixed equally and evenly. For solid raw materials in powder form such as premix, there are flange-connected, wide-section entrance sections. After the mixing process, the bottom covers that can be opened completely prevent residue formation in the mixer and the discharging process takes place in a very serial manner. There is an air by-pass line on the mixer to ensure the air circulation control that occurs during the entry and discharge processes.

## FEATURES

- Reinforced Structure
- High Strength Special Circular Design
- Minimum Mixing Time
- Perfect Mix with High Homogeneity
- Superior Capacity Performance
- High Production Capacity
- Short Downtime
- Effective Sealing Elements
- Heavy Duty Block Bearings
- Easy Use and Maintenance

## DRIVE SYSTEM

- Geared Motor
- Direct Coupled and Belt Pulley Connection Power Transmission Options
- IE3 Class High Efficiency Electric Motor (IE4 - Optional)

## SECURITY SYSTEM

- Safety Sensor on Covers
- Bearing Heat Detection Sensor (Option)

## ACCESSORIES

- Wide Maintenance and Intervention Covers
- Air By-Pass Channel
- Balanced Distribution with Liquid Inlet Nozzles
- Angle Adjustable Paddles
- Electro-Pneumatic Controlled Product Entry Cover
- Drain Cover Locking System

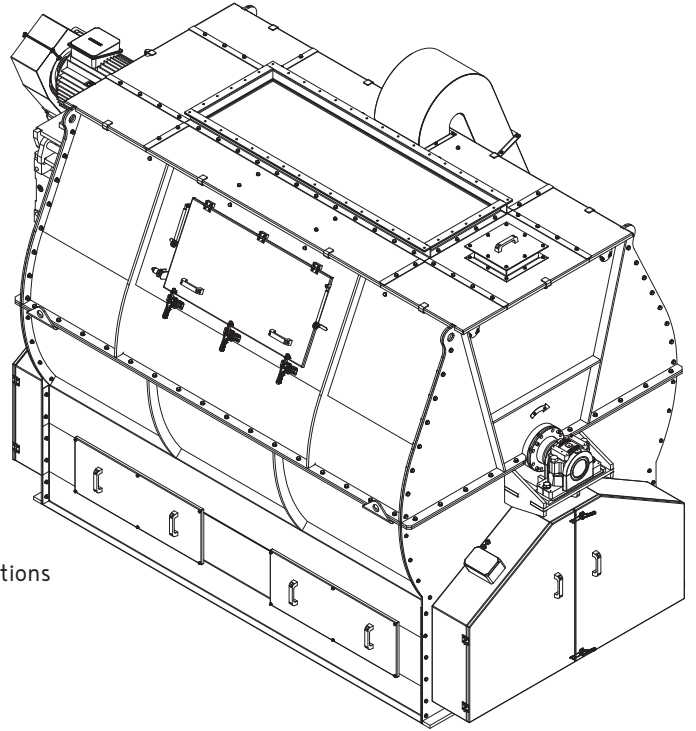

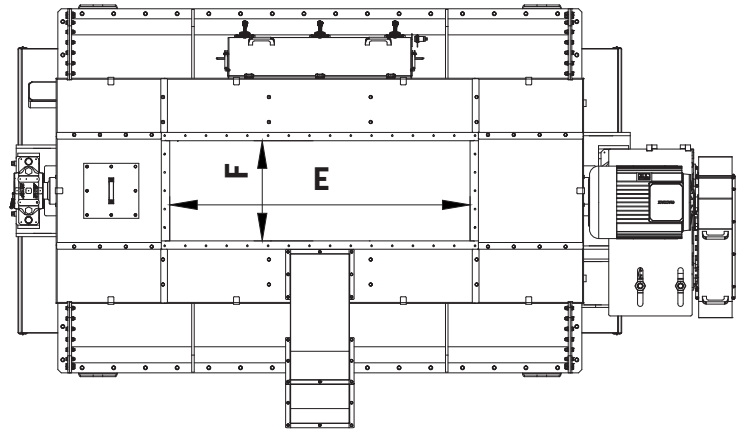
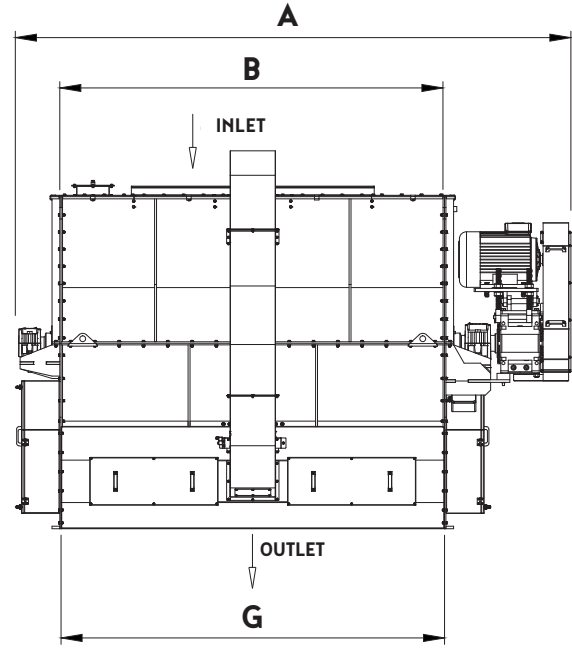
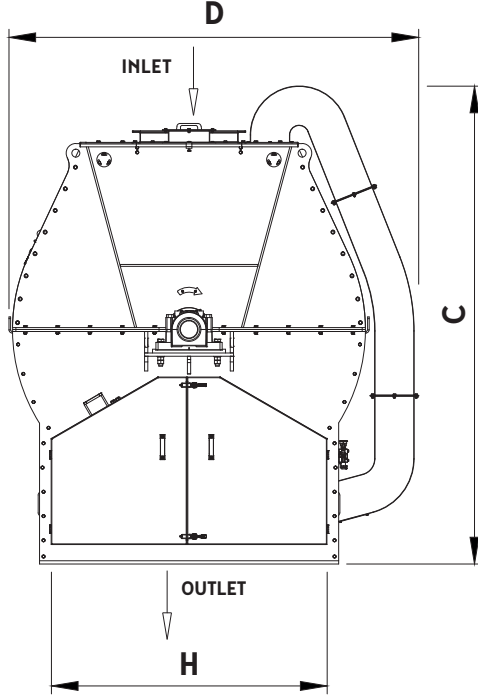

Type	Motor Power (kW)	Effective - Total Volume (m <sup>3</sup> )	Dimensions (mm)							
			A	B	C	D	E	F	G	H
PK0050	5,5	0,40 - 0,52	2.035	1.400	1.300	830	600	300	300	400
PK0125	7,5	1,25 - 1,8	2.600	1.600	2.060	1.450	500	500	1.600	1.050
PK0225	18,5	2,25 - 3,8	3.230	2.200	2.500	1.850	1.200	600	2.150	1.450
PK0325	22	3,25 - 5,9	3.600	2.400	2.530	2.100	1.500	600	2.400	1.500
PK0481	37	4,8 - 6,8	3.800	2.700	2.700	2.200	1.500	600	2.700	1.700
PK0650	45	6,5 - 10,5	4.300	3.000	2.950	2.500	1.800	600	3.000	1.750
PK0850	55	8,5 - 13	4.875	3.250	3.025	2.650	2.000	600	3.000	1.900
PK1250	90	12,5 - 18	6.600	4.300	3.150	2.830	3.000	600	4.300	2.000
PK1800	110	18 - 22	6.660	4.300	3.400	3.000	3.000	600	4.300	2.100

The designs and dimensions may be modified without notice.