



## TWO-WAY VALVE

**ALTINBILEK Two-way Valve**, ensures that raw materials and products in powder or granular form are guided seamlessly to their intended targets. The valve designed as 1 input and 2 outputs has a completely closed and impermeable structure. It consists of a closed body and a guiding mechanism ensuring flow control. Electric, Manual or Pneumatic controlled models are specially designed according to the needs and the enterprise.

### FEATURES

- It can be manufactured in any dimensions (the height varies depending on the angle)
- L and V type versions
- 45° and 60° Standard versions (Manufacture in special dimension available)
- Bolted joint, Easy-to-assemble Body Structure, and Maximum Endurance
- Easy-to-open Maintenance, Inspection, and Cleaning thanks to Inspection Hatch

### DRIVE SYSTEM

- Drive System Mountable at Right or Left
- Power Transmission with Shaft Connection (Standard)

### SECURITY SYSTEM

- Limit Sensor (Standard)
- Braked Motor (Standard)
- Lock Mechanism for Manual Clamp (Standard)

### TECHNICAL SPECIFICATIONS

Drive System	Electric Motor
	Manual Hand Wheel
	Pneumatic Piston
Operating Conditions	-15°C to 40°C ambient temperature

### MATERIALS

Body	Standard	Galvanized Steel and Hot Dipped Galvanized Coating
	Optional	Stainless Painted (Carbon Steel)
Wear Plates	Standard	Hardox 450
	Optional	Polyethylene (UHMW-PE)

### ACCESSORIES:

- Transparent Observation Hatch
- Sensor Housing

**Electric Controlled**

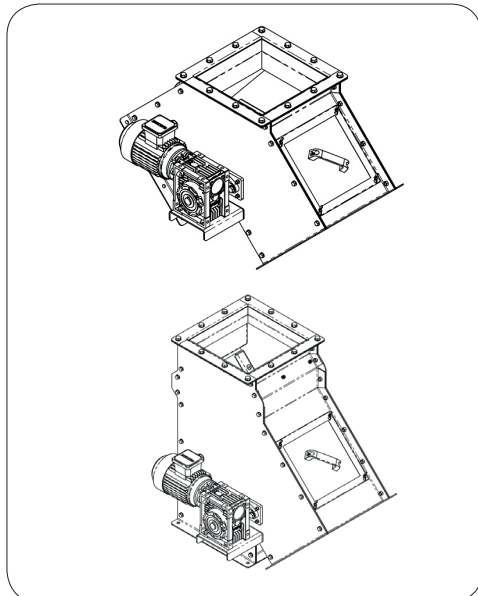

**Manual Controlled**

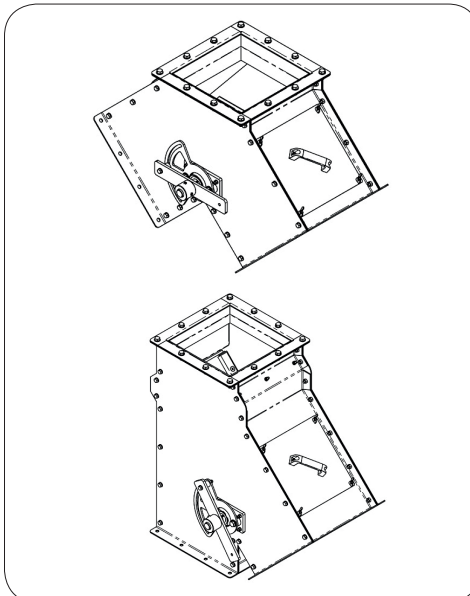

**Pneumatic Controlled**

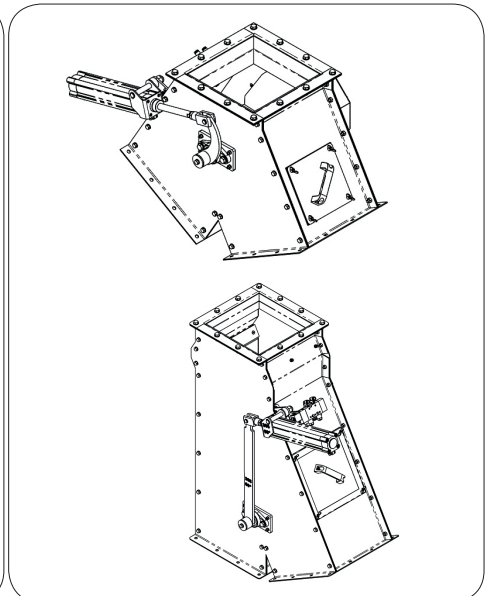



## TWO-WAY VALVE

### L Type Dimensions

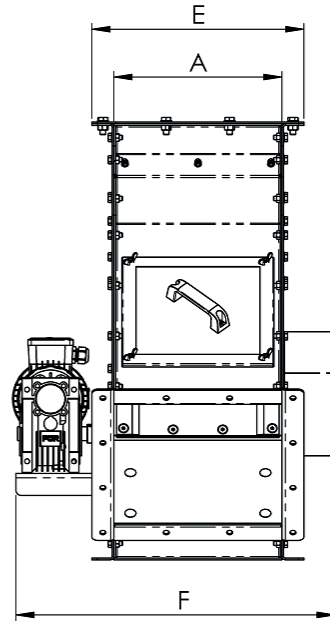
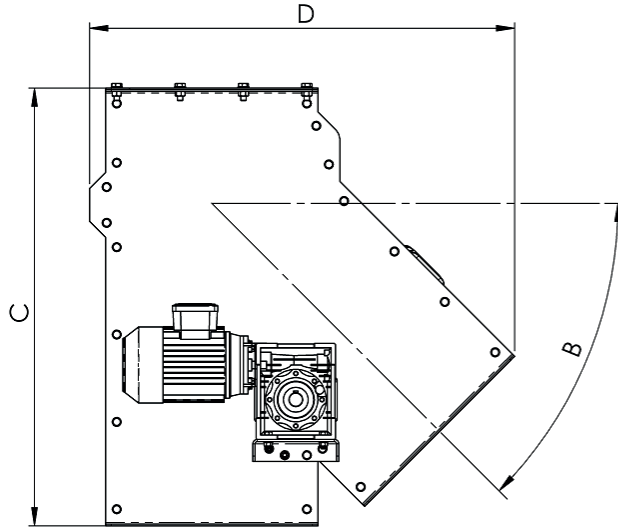

MODEL	A (mm)	B (°)	C (mm)	D (mm)	E (mm)	F (mm)		
						Electric Controlled	Manual Controlled	Pneumatic Controlled
180x180	180	45	616	558	260	455	343	382
		60	782	560				
230x230	230	45	687	643	310	505	393	432
		60	882	653				
265x265	265	45	736	703	345	540	428	467
		60	952	717				
305x305	305	45	793	771	385	580	468	507
		60	1032	793				
340x340	340	45	843	831	420	615	503	542
		60	1102	858				
420x420	420	45	956	967	500	695	583	622
		60	1262	1008				
450x450	450	45	998	1018	530	725	613	652
		60	1352	1079				
540x540	540	45	1125	1172	620	815	703	742
		60	1532	1247				

Designs and dimensions are subject to change without notice.



## TWO-WAY VALVE

### V Type Dimensions

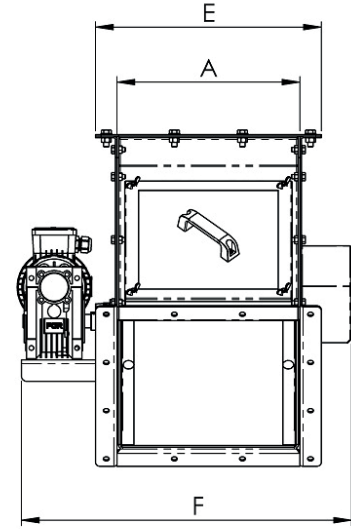
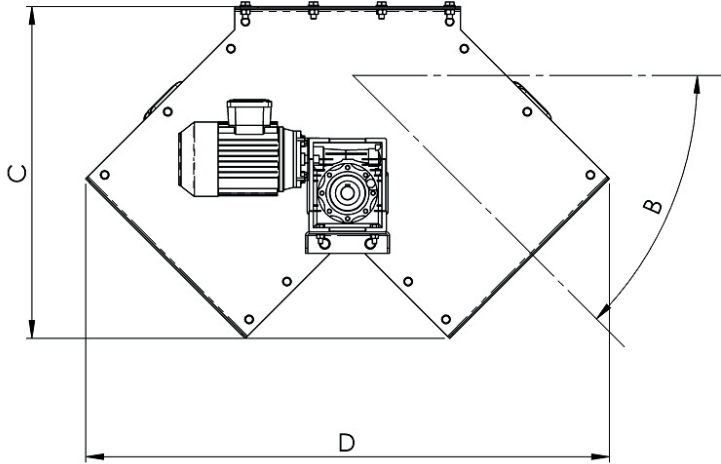

MODEL	A (mm)	B (°)	C (mm)	D (mm)	E (mm)	F (mm)		
						Electric Controlled	Manual Controlled	Pneumatic Controlled
180x180	180	45	359	524	260	455	343	382
		60	448	578				
230x230	230	45	439	664	345	540	393	432
		60	555	722				
265x265	265	45	496	763	420	615	428	467
		60	630	823				
305x305	305	45	560	875	530	725	468	507
		60	715	939				
340x340	340	45	617	974	420	615	503	542
		60	790	1040				
420x420	420	45	740	1187	500	695	583	622
		60	960	1271				
450x450	450	45	789	1273	530	725	613	652
		60	1024	1357				
540x540	540	45	935	1527	620	815	703	742
		60	1216	1617				

Designs and dimensions are subject to change without notice.

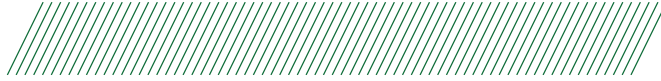

## THREE-WAY VALVE

**ALTINBILEK Three-way Valve**, ensures that raw materials and products in powder or granular form are guided seamlessly to their intended targets. The valve designed as 1 input and 3 outputs has a completely closed and impermeable structure. It consists of a closed body and a guiding mechanism ensuring flow control. Electric, Manual or Pneumatic controlled models are specially designed according to the needs and the enterprise.

## FEATURES

- It can be manufactured in any dimensions (the height varies depending on the angle)
- L and V type versions
- 45° and 60° Standard versions (Manufacture in special dimension available)
- Bolted joint, Easy-to-assemble Body Structure, and Maximum Endurance
- Easy-to-open Maintenance, Inspection, and Cleaning thanks to Inspection Hatch

## DRIVE SYSTEM

- Drive System Mountable at Right or Left
- Power Transmission with Shaft Connection (Standard)

## SECURITY SYSTEM

- Limit Sensor (Standard)
- Braked Motor (Standard)
- Lock Mechanism for Manual Clamp (Standard)

Electric Controlled

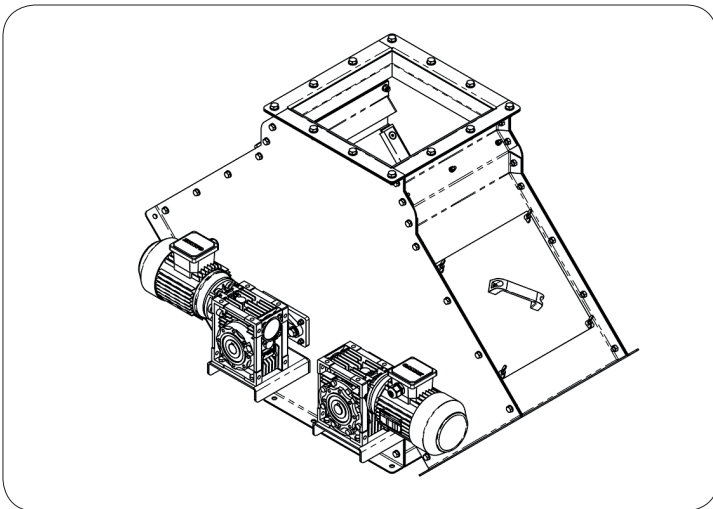

Pneumatic Controlled

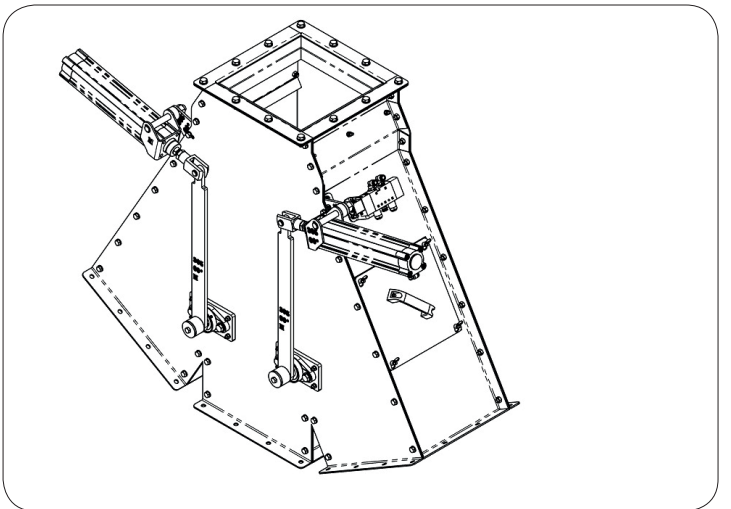

## TECHNICAL SPECIFICATIONS

Drive System	Electric Motor
	Pneumatic Piston
Operating Conditions	-15°C ÷ 40°C ambient temperature

## MATERIALS

Body	Standard	Galvanized Steel and Hot Dipped Galvanized Coating
	Optional	Stainless Painted (Carbon Steel)
Wear Plates	Standard	Hardox 450
	Optional	Polyethylene (UHMW-PE)

## ACCESSORIES:

- Transparent Observation Hatch
- Sensor Housing



## THREE-WAY VALVE

### Motor-type Dimensions

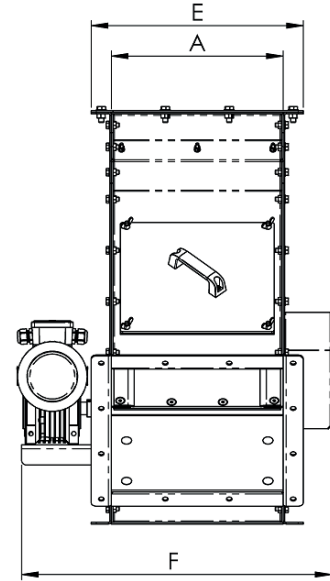
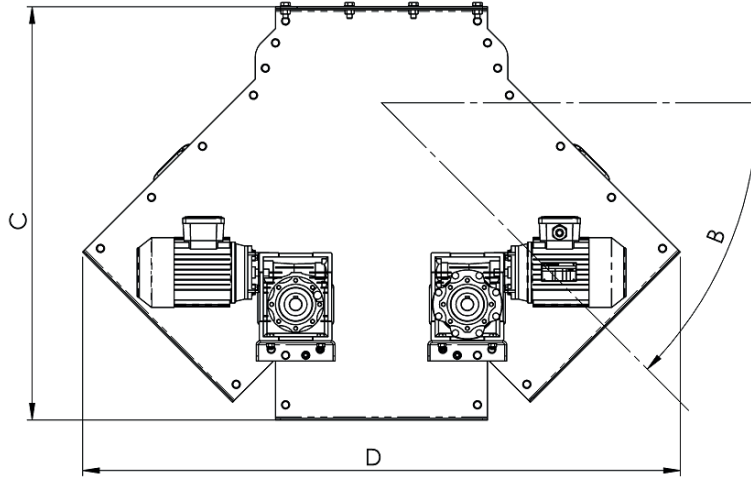

MODEL	A (mm)	B (°)	C (mm)	D (mm)	E (mm)	F (mm)
230x230	230	45	661	918	310	518
265x265	265	45	710	1002	345	553
305x305	305	45	767	1099	385	593
340x340	340	45	816	1183	420	628
420x420	420	45	930	1376	500	708
450x450	450	45	972	1449	530	738
540x540	540	45	1099	1666	620	828

Designs and dimensions are subject to change without notice.



## THREE-WAY VALVE

### Pneumatic Dimensions

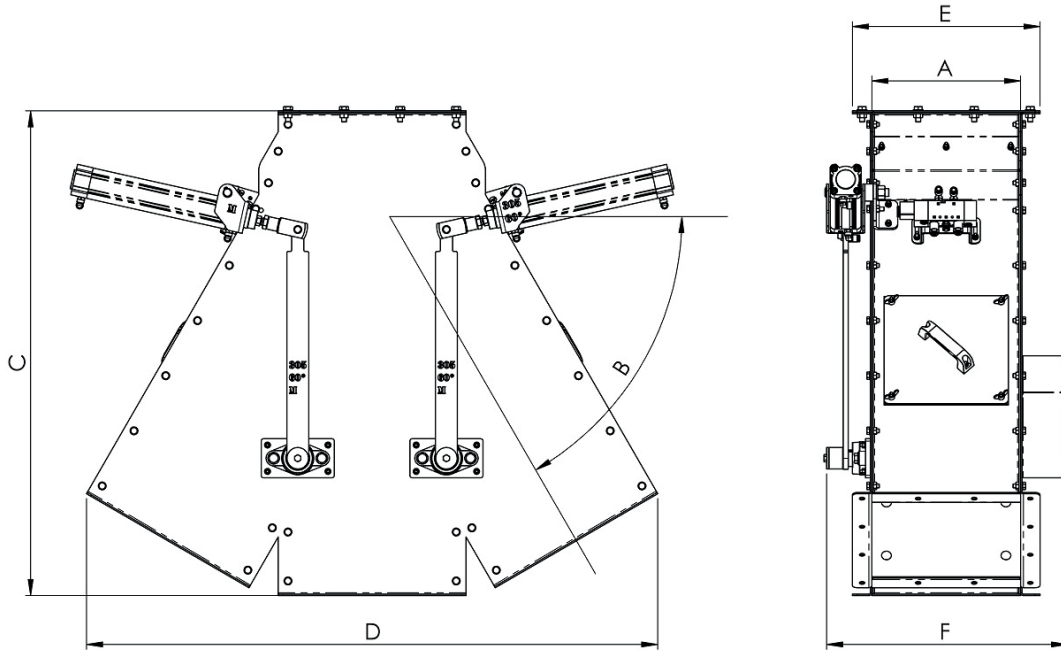

MODEL	A (mm)	B (°)	C (mm)	D (mm)	E (mm)	F (mm)
230x230	230	60	843	965	310	420
265x265	265	60	903	1048	345	455
305x305	305	60	993	1168	385	495
340x340	340	60	1063	1267	420	530
420x420	420	60	1223	1485	500	610
450x450	450	60	1283	1566	530	640
540x540	540	60	1463	1810	620	730

Designs and dimensions are subject to change without notice.



## THREE-WAY VALVE Swing Type

**ALTINBİLEK Three-way Valve**, ensures that raw materials and products in powder or granular form are guided seamlessly to their intended targets. The valve designed as 1 input and 3 outputs has a completely closed and impermeable structure. It consists of a closed body and a guiding mechanism ensuring flow control. Electric, Manual or Pneumatic controlled models are specially designed according to the needs and the enterprise.

### FEATURES

- İstenilen Ebatlarda Yapılabilir (Yükseklik Açıya Göre Değişkenlik Gösterir)
- L ve V tip Versiyonlar
- 45° ve 60° Standart Versiyonlar (Özel Ölçü Yapılabilir)
- Cıvatalı Birleştirme, Kolay Montajlı Gövde Yapısı ve Maksimum Dayanıklılık
- Müdahale Kapağı Sayesinde Kolay Açılır Bakım, Kontrol ve Temizleme

### TAHRİK SİSTEMİ

- Sağ veya Sol Tarafa Monte Edilebilen Tahrik Sistemi
- Mil Bağlantılı Güç Aktarımı (Standart)

### GÜVENLİK SİSTEMİ

- Limit Sensörü (Standart)
- Frenli Motor (Standart)
- Manuel Klape İçin Kilit Mekanizması (Standart)

### TECHNICAL SPECIFICATIONS

Drive System	Electric Motor
Operating Conditions	-15°C ÷ 40°C ambient temperature

### MATERIALS

Body	Standard	Galvanized Steel and Hot Dipped Galvanized Coating
	Optional	Stainless Painted (Carbon Steel)
Wear Plates	Standard	Hardox 450
	Optional	Polyethylene (UHMW-PE)

### AKSESUARLAR

- Şeffaf Gözlem Penceresi
- Sensör Muhafaza

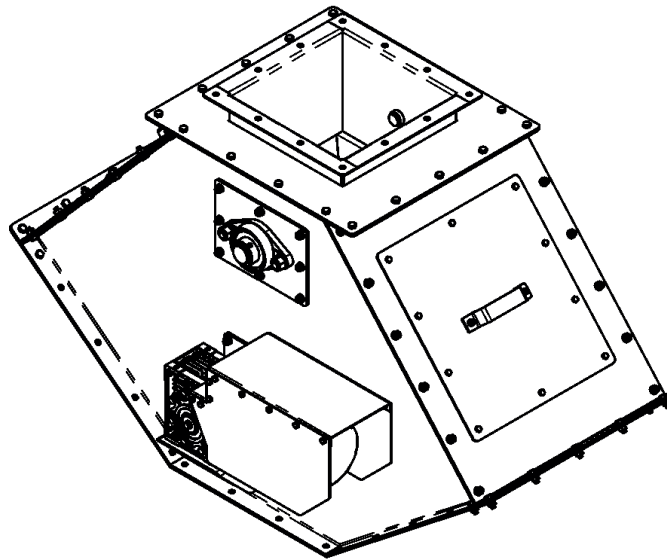



## THREE-WAY VALVE

### Swing Type Dimensions

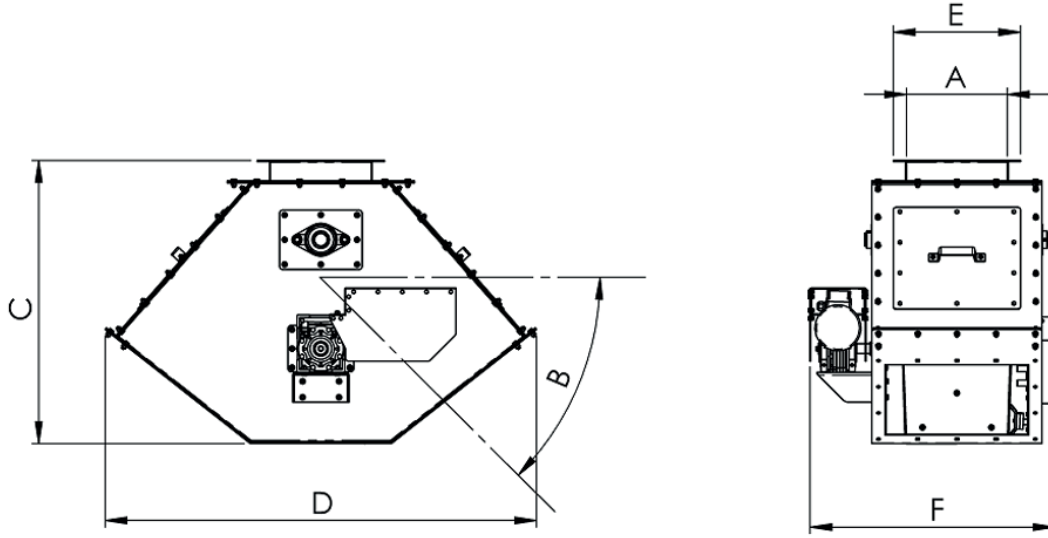

MODEL	A (mm)	B (°)	C (mm)	D (mm)	E (mm)	F (mm)
230x230	230	45	768	1112	310	666
305x305	305	45	857	1306	385	742
340x340	340	45	913	1392	420	778
420x420	420	45	1101	1589	500	856
450x450	450	45	1052	1671	530	886

Designs and dimensions are subject to change without notice.